

# OPEN

## Compute Project

EP100-S1 (Wiwynn 1U openEdge server)

Revision 0.2

### Authors:

Nick HY Wang, HW Engineer, Wiwynn Corporation

Ray Chen, ME Engineer, Wiwynn Corporation

Shawn Ma, Thermal Engineer, Wiwynn Corporation

# 1 License (OCP CLA Option)

Contributions to this Specification are made under the terms and conditions set forth in **Open Compute Project Contribution License Agreement (“OCP CLA”)** (“Contribution License”) by: **Wiwynn Cooperation**.

You can review the signed copies of the applicable Contributor License(s) for this Specification on the OCP website at <http://www.opencompute.org/products/specsanddesign>

Usage of this Specification is governed by the terms and conditions set forth in **Open Compute Project Hardware License – Permissive (“OCPHL Permissive”), (“Specification License”)**.

You can review the applicable Specification License(s) executed by the above referenced contributors to this Specification on the OCP website at <http://www.opencompute.org/participate/legal-documents/>

NOTWITHSTANDING THE FOREGOING LICENSES, THIS SPECIFICATION IS PROVIDED BY OCP "AS IS" AND OCP EXPRESSLY DISCLAIMS ANY WARRANTIES (EXPRESS, IMPLIED, OR OTHERWISE), INCLUDING IMPLIED WARRANTIES OF MERCHANTABILITY, NON- INFRINGEMENT, FITNESS FOR A PARTICULAR PURPOSE, OR TITLE, RELATED TO THE SPECIFICATION. NOTICE IS HEREBY GIVEN, THAT OTHER RIGHTS NOT GRANTED AS SET FORTH ABOVE, INCLUDING WITHOUT LIMITATION, RIGHTS OF THIRD PARTIES WHO DID NOT EXECUTE THE ABOVE LICENSES, MAY BE IMPLICATED BY THE IMPLEMENTATION OF OR COMPLIANCE WITH THIS SPECIFICATION. OCP IS NOT RESPONSIBLE FOR IDENTIFYING RIGHTS FOR WHICH A LICENSE MAY BE REQUIRED IN ORDER TO IMPLEMENT THIS SPECIFICATION. THE ENTIRE RISK AS TO IMPLEMENTING OR OTHERWISE USING THE SPECIFICATION IS ASSUMED BY YOU. IN NO EVENT WILL OCP BE LIABLE TO YOU FOR ANY MONETARY DAMAGES WITH RESPECT TO ANY CLAIMS RELATED TO, OR ARISING OUT OF YOUR USE OF THIS SPECIFICATION, INCLUDING BUT NOT LIMITED TO ANY LIABILITY FOR LOST PROFITS OR ANY CONSEQUENTIAL, INCIDENTAL, INDIRECT, SPECIAL OR PUNITIVE DAMAGES OF ANY CHARACTER FROM ANY CAUSES OF ACTION OF ANY KIND WITH RESPECT TO THIS SPECIFICATION, WHETHER BASED ON BREACH OF CONTRACT, TORT (INCLUDING NEGLIGENCE), OR OTHERWISE, AND EVEN IF OCP HAS BEEN ADVISED OF THE POSSIBILITY OF SUCH DAMAGE.

## Revision history

Revision	Editor	Description
V0.1 (July, 2020)	Frank Ty Chen	First draft
V0.2 (August, 2020)	Frank Ty Chen	Revise author names

# Contents

- 1 License (OCP CLA Option) ..... 2
- 2 Introduction ..... 5
- 3 Product Architecture Overview ..... 5
  - 3.1 Server Board Block Diagram ..... 6
  - 3.2 Server Board ..... 7
    - 3.2.1 Server Board Placement ..... 7
    - 3.2.2 Server Board Dimension ..... 8
    - 3.2.3 Processor ..... 8
    - 3.2.4 PCH ..... 9
    - 3.2.5 Memory ..... 10
    - 3.2.6 PCIE Lanes ..... 11
    - 3.2.7 SATA, U.2 and M.2 ..... 11
    - 3.2.8 USB ..... 12
    - 3.2.9 AST2500 ..... 12
    - 3.2.10 TPM ..... 13
    - 3.2.11 UART ..... 13
    - 3.2.12 LOM ..... 13
    - 3.2.13 Power Connector for Accelerator Card ..... 14
    - 3.2.14 Thermal Design ..... 14
- 4 Chassis Spec ..... 16
  - 4.1 1U Sled Overview ..... 16

## 2 Introduction

Wiwynn EP100 is designed based on the OpenEdge Server concept to fulfill various Edge computing requirements and use cases.

EP100 is a single-socket server that supports the Purley Platform Xeon-SP processors in combination with the Lewisburg PCH (PCH) to provide a balanced feature set between technology leadership and cost.

This specification defines the interfaces and connection topology of various buses and control signals in the compute node.

## 3 Product Architecture Overview

EP100-S1 Edge Server main characteristics and features are listed below:

**Table 1: Server Feature List**

Item Name	Specifications
Form Factor	215mm x 421.8mm x 41mm (W x D x H), 1RU Height
Power Supply	DC 12V from Backplane
Fan	4x 4056 PWM Fan, Fans are controlled by the BMC in Sled.
MB	412.4mm x 205.8mm
CPU	1x Intel Skylake / Cascade Lake, U- (Design reserve) & N-type SKUs
System Chipset	1x Intel Lewisburg PCH C621 (C627 for QAT Option)
Memory	8x ECC DIMM Slots : Option 1 : 8x DDR4 R DIMM Option 2 : 6x DDR4 R DIMM + 2x DCPMM DIMM
Sled Management	ASPEED AST2500 with VGA
Boot/Data Drive	- Support two boot drive with M.2 PCIe Gen3 x4 port (support 2280/22110) - Support two U.2 7-mm drives with PCIe Gen3 x4 each, or two SATA 7mm SSD
Expansion Slots	- One PCIe Gen3 x16 OCP 3.0 Slot - One PCIe FHHL Gen3 x16 Slots
IO Ports	- OCP NIC 3.0, VGA port, USB, Debug port
Sled LED Indicators	- Power, UID,
Sled Button	- Power, UID, RST

### 3.1 Server Board Block Diagram

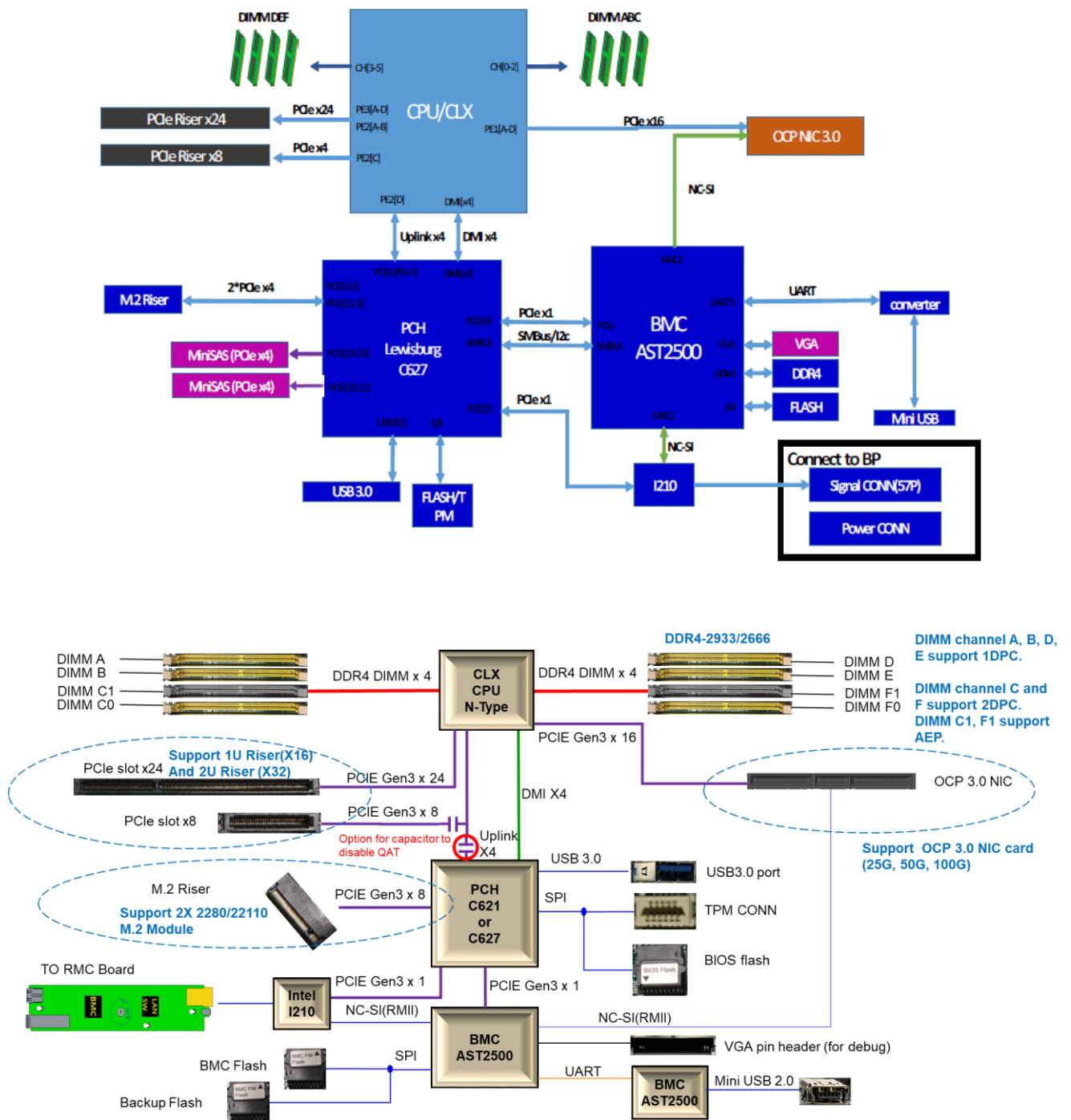

Figure 1: Server Board Block Diagram

### 3.2 Server Board

#### 3.2.1 Server Board Placement

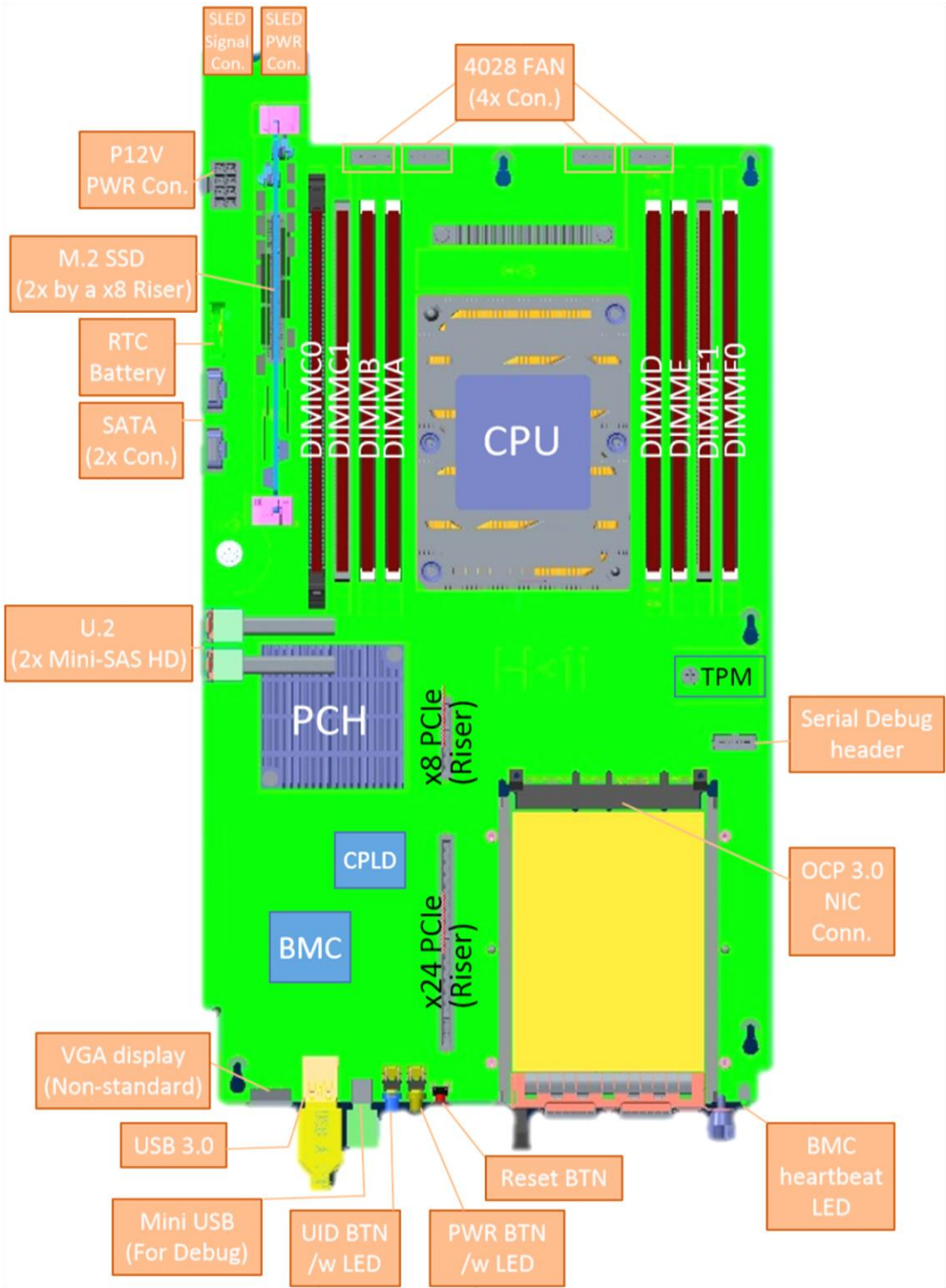
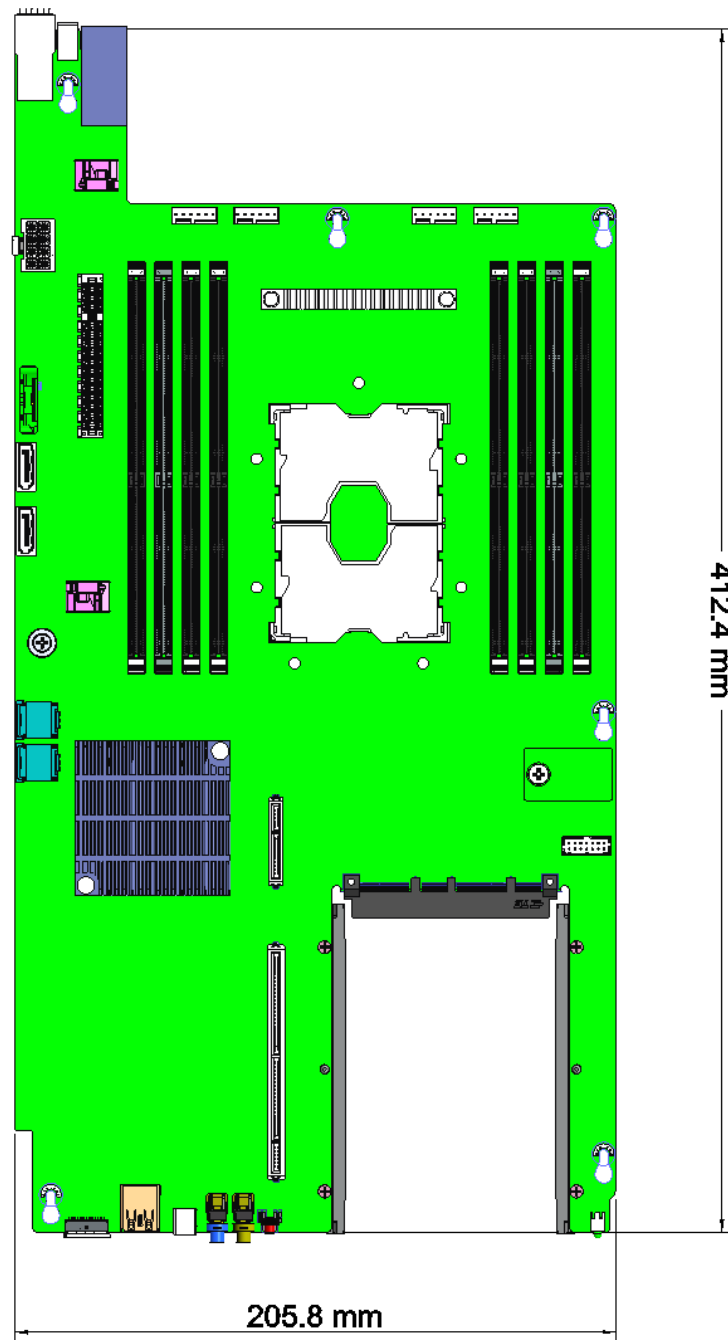

Figure 2: Server Board Placement

### 3.2.2 Server Board Dimension

Server Board dimensions are 205.8 mm (W) x 412.4 mm (L).



**Figure 3: Server Main Board Dimensions**

### 3.2.3 Processor

The Cascade Lake SP is the next generation of Intel® Xeon® SP processor built on 14-nm process technology. The processor is designed for a platform consisting of at least one Cascade Lake SP processor and the Platform Controller Hub (PCH). Included in this family of processors are integrated memory controller (IMC) and an Integrated I/O (IIO) on a single silicon die.



All processor types support up to 48 lanes of PCI Express\* 3.0 links capable of 8.0 GT/s. It features two Integrated Memory Controllers (IMC), each IMC supporting up to 3 channels of DDR4 DIMMs with up to two DIMMs per channel.

### 3.2.4 PCH

The PCH's core name of Purley platform is named "Lewisburg". It is an Intel C620 series chipset.

#### **Lewisburg Key Features:**

- ACPI Power Management Logic Support, Revision 4.0a
- PCI Express\* Base Specification Revision 3.0
- Integrated Serial ATA host controller supports data transfer rates of up to 6 Gb/s on all ports.
- xHCI USB controller with SuperSpeed USB 3.0 ports
- Direct Media Interface
- Serial Peripheral Interface
- Enhanced Serial Peripheral Interface
- Flexible I/O—Allows some high speed I/O signals to be configured as PCIE root ports, PCIE uplink for use with certain PCH SKUs, SATA (and sSATA), or USB 3.0.
- General Purpose Input Output (GPIO)
- Low Pin Count interface, interrupt controller, and timer functions
- System Management Bus Specification, Version 2.0
- Integrated Clock Controller / Real Time Clock Controller
- Intel® High Definition Audio and Intel® Smart Sound Technology
- Integrated 10/1 Gb Ethernet
- Integrated 10/100/1000 Gigabit Ethernet MAC
- Supports Intel® Rapid Storage Technology Enterprise
- Supports Intel® Active Management Technology and Server Platform Services
- Supports Intel® Virtualization Technology for Directed I/O
- Supports Intel® Trusted Execution Technology
- JTAG Boundary Scan support
- Intel® QuickAssist Technology
- Intel® Trace Hub for debug.
- Innovation Engine
- ADR Support

### 3.2.5 Memory

There are six memory channels (A, B, C, D, E, F) in the server board design and it supports eight DIMM slots. CH A, B, D and E are 1DPC. CH C and F are 2 DPC. CH C and F also support Intel AEP. Here is the population matrix.

	Channel A	Channel B	Channel C		Channel D	Channel E	Channel F	
	Slot 0	Slot 0	Slot 0	Slot1	Slot 0	Slot 0	Slot 0	Slot1
Config1	DRAM	DRAM	DRAM	DRAM	DRAM	DRAM	DRAM	DRAM
Config2	DRAM	DRAM	DRAM	Empty	DRAM	DRAM	DRAM	Empty
Config3	DRAM	DRAM	DRAM	AEP	DRAM	DRAM	DRAM	AEP
Config4	DRAM	DRAM	AEP	Empty	DRAM	DRAM	AEP	Empty

The DIMM identifiers on the silkscreen on the board provide information about the channel to which they belong. For example, DIMM\_A0 is the first slot on Channel A of processor.

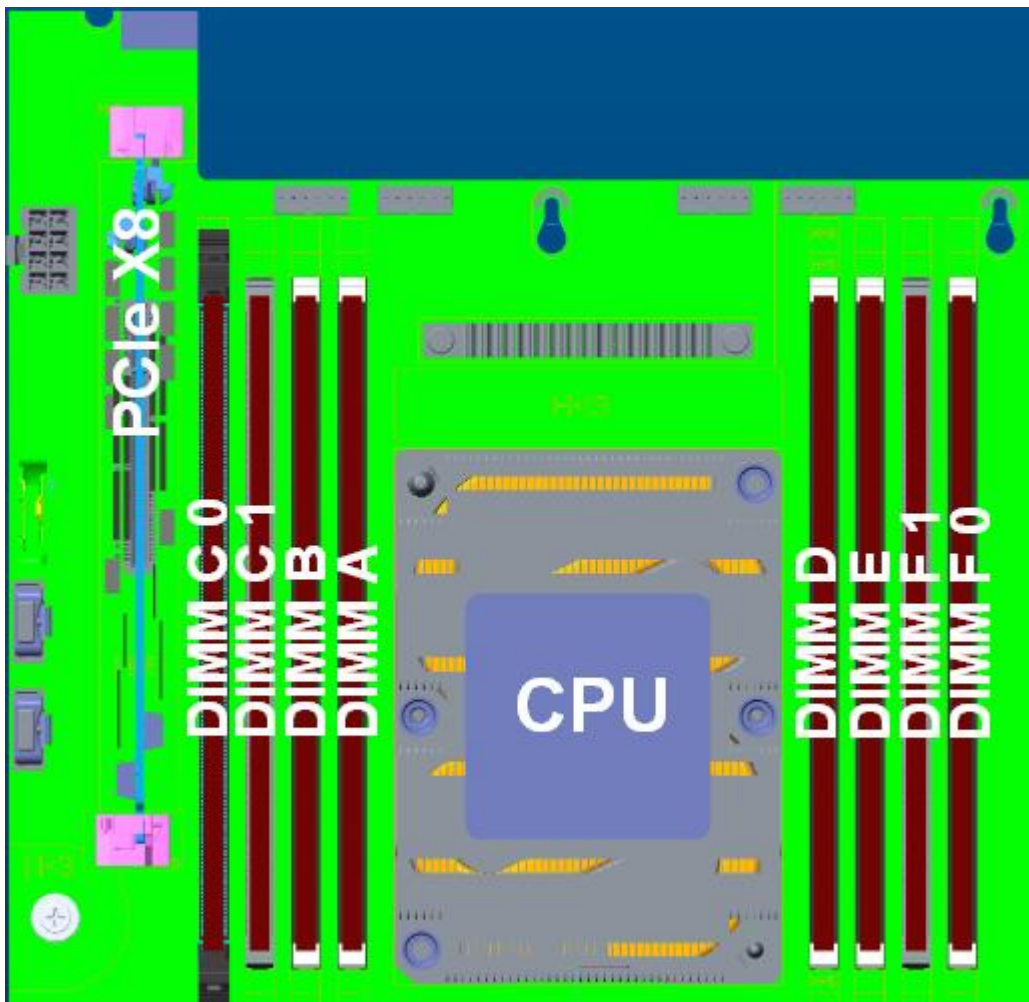

Figure 4: Server Sled DDR Physical Slots

### 3.2.6 PCIE Lanes

#### CPU PCIE Port2

The PCIE x8 lanes between CPU, PCH and X8 PCIe slot connector are in group of PCIE x 4 lanes.

#### Configuration 1:

PCH is C621.

CPU PCIE P2CD PCIE x 8 lanes are connecting to PCIe x8 Slot.

#### Configuration 2

PCH is C627 and supports PCIe x4(P2D) for QuickAssist.

CPU PCIE P2C PCIE x 4 lanes are connecting to PCIe x8 Slot.

### 3.2.7 SATA, U.2 and M.2

The PCH has two integrated SATA host controllers that support independent DMA operation.

EP100 has two M.2 (supporting NVMe M.2 2280 and 22110), two mini-SAS HD connectors (PCIe protocol) and two 7p SATA connectors. Mini-SAS HD connectors with connection to PCH PCIe Gen3 support two U.2 NVMe. Boot drive can choose from U.2 or M.2.



### 3.2.8 USB

The Lewisburg PCH supports total 14 USB ports, six USB 2.0 ports and eight USB 3.0 ports. The USB port distribution of EP100-S1 Edge Server is as follows:

- ASPEED BMC AST2500 consumes two USB 2.0 ports (one 1.1 and one 2.0)
- One USB3.0 port in front side
- One Mini USB port for debugging in front side

The USB ports on the products are not required to be powered from STBY.

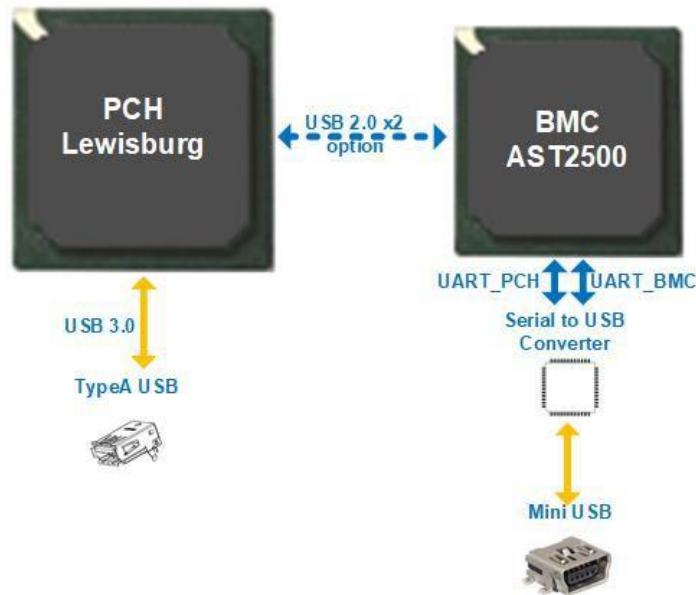

Figure 5: Server USB Ports

### 3.2.9 AST2500

The Server's Board Management Controller (**AST2500**) is a highly integrated single-chip solution, integrating several devices typically found on servers.

#### VGA Display Controller

- Fully IBM VGA compliant
- Maximum Display resolution: 1920x1200 32bpp@60Hz (reduced blanking)
- Support widescreen resolutions:
  - WXGA: 1280x800 32/16bpp @60Hz
  - WXGA+: 1440x900 32/16bpp @60Hz
  - WSXGA+ : 1680x1050 32/16bpp @60Hz
  - FullHD+ : 1920x1080 32/16bpp @60Hz

### DDR3L/DDR4 SDRAM Controller

- Support external 16-bit DDR3L/DDR4 SDRAM data bus width
- Maximum memory clock frequency
  - DDR3L: 800MHz (DDR3-1600)
  - DDR4: 800MHz (DDR4-1600)

#### 3.2.10 TPM

EP100-S1 Edge Server's PCH supports TPM specification 2.0 implemented with a TPM header on server sled. It supports SPI interface TPM 2.0 module.

#### 3.2.11 UART

EP100-S1 Edge Server provides Host and BMC UART interfaces for development purpose. Both UARTs connect to a UART to USB converter on the server board. The USB connect to a mini-USB connector at the front IO. User can use an USB cable to link the USB port to laptop to access the UARTs.

#### 3.2.12 LOM

The LOM solution in EP100-S1 Edge Server is Intel Ethernet controller I210-AT. I210-AT is a single port, compact, low power component that supports GbE designs. The I210 offers a fully-integrated GbE Media Access Control (MAC). The I210-AT enables 1000BASE-T implementations using an integrated PHY. Below are the features of I210-AT

- Operating Temperature: 0 to 70 °C.
- PCIE v2.1 (2.5 GT/s) x1 is used by the I210 as a host interface. In EP100-S1 Edge Server, the PCIE interface connects to PCH PCIE port.
- Network Interface: 1000 Base-T. In server sled, the 1000 Base-T is routing on the server sled towards the back plane.

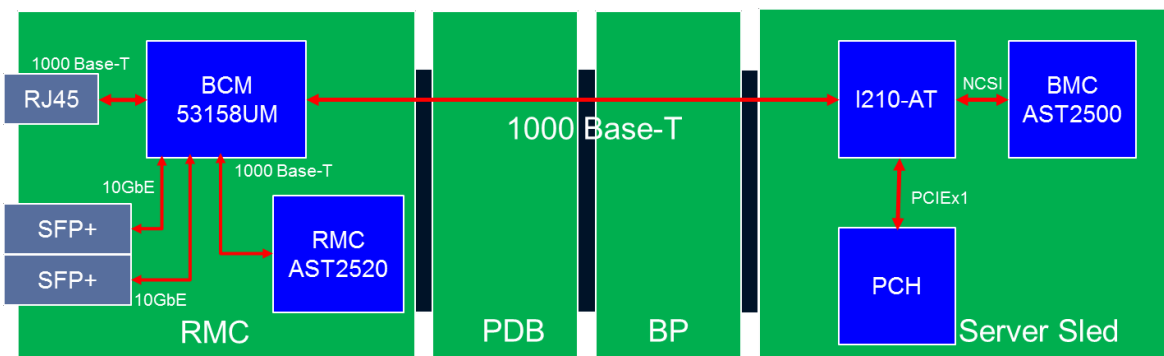

**Figure 6: 1000 Base-T routing topology**

- It provides the following capabilities for the BMC on the server sled:
  1. A dedicated 1000 BASE-T Ethernet port for hardware management. User can remote manage the server sled via this interface.
  2. RMC can get the sled information via this interface.
- Manageability: NCSI interface. This is accomplished by providing mechanisms by which manageability network traffic is routed to and from BMC.
  - In EP100-S1 Edge Server, NCSI interface is connected to BMC. The usable bandwidth for either direction is up to 100 Mb/s for the NCSI interface.

### 3.2.13 Power Connector for Accelerator Card

EP100-S1 Edge Server can support FHHL accelerator card. The accelerator card needs the external 12V power feed via the cable. There is an 8-pin power connector on the server sled to offer the 12V power feed for accelerator.

### 3.2.14 Thermal Design

#### 3.2.14.1 Thermal solution for 1U sled

##### CPU Heat Sink

- Dimensions=78\*108\*25.5 mm<sup>3</sup>
- Material=Al base + Cu block + Al Fin

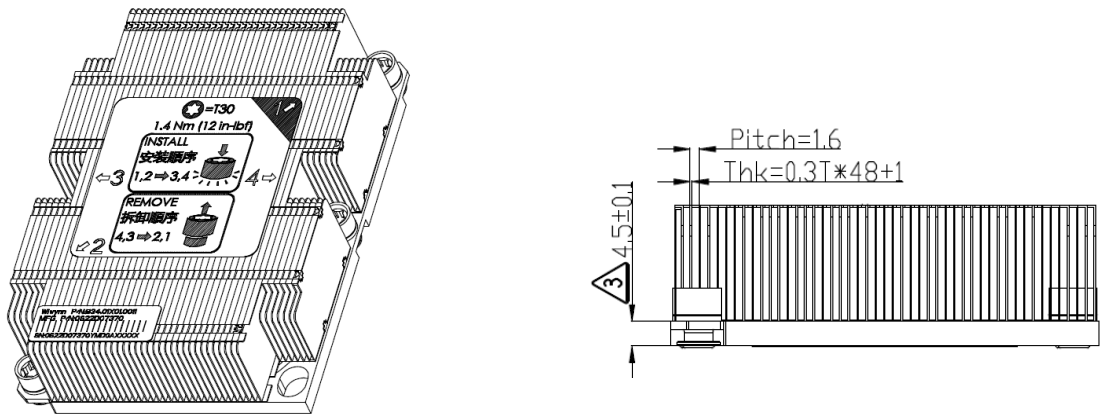
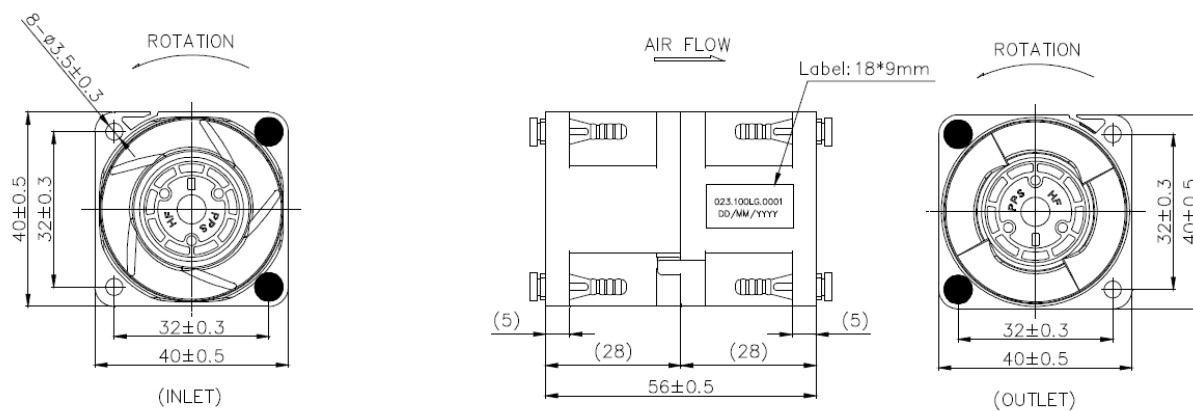

Figure 7: 1U CPU Heat Sink

## System Fan x4

- Dimensions=4056 (dual rotor)
- Voltage:12 V



**Figure 8: 4056 Fan Drawing**

## 4 Chassis Spec

### 4.1 1U Sled Overview

Dimensions are 475mm (D) x 215mm (W) x 4 mm (H).

2U chassis can support these configurations:

- Two M.2 cards
- One x16 FHHL PCIE card
- Two local 2.5" 7mm wide NVMe or SATA disks

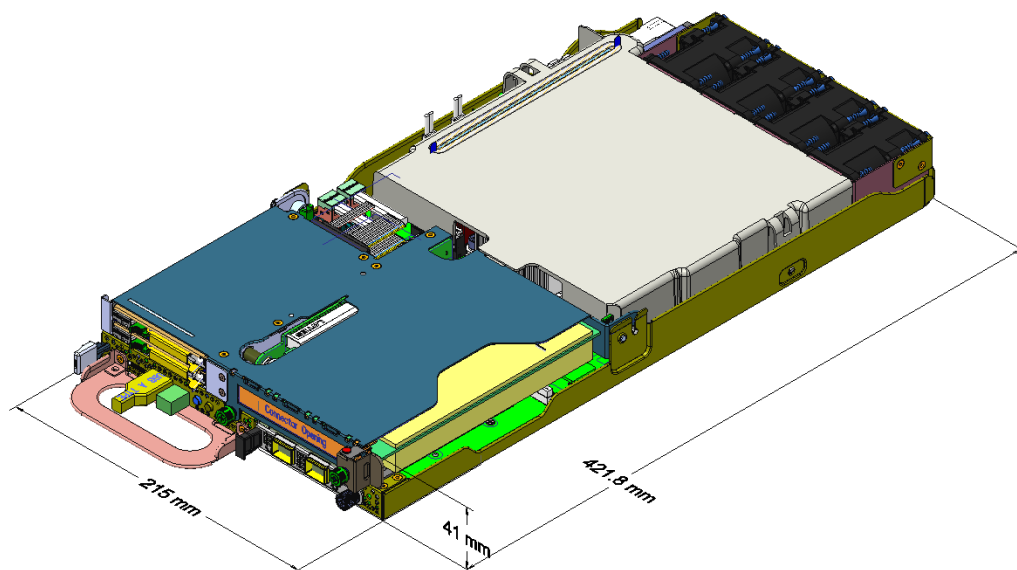

Figure 9: 1U Sled Overview



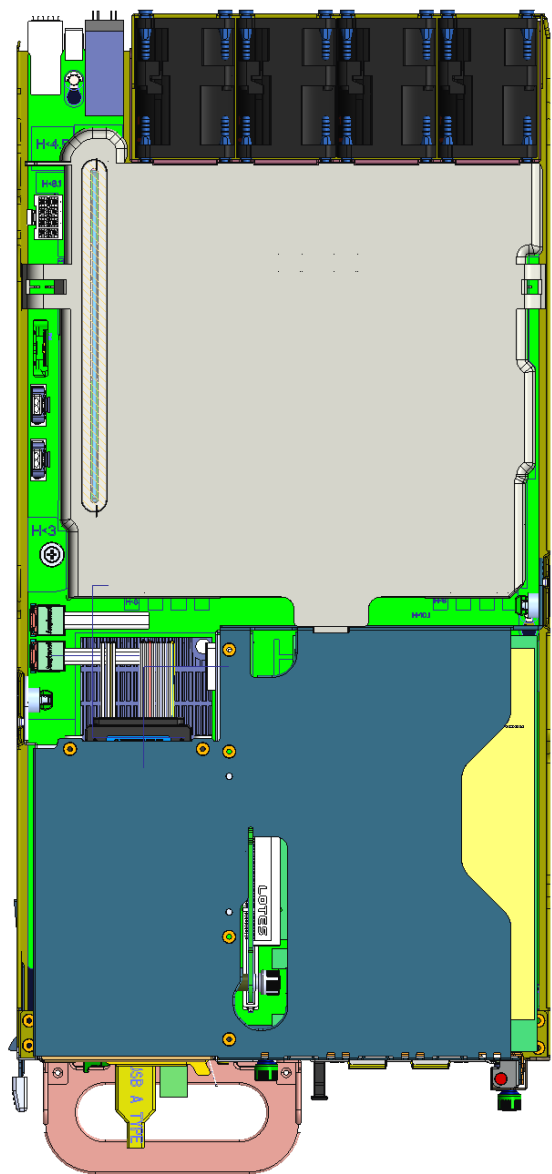

Figure 10: 1U Sled Top View

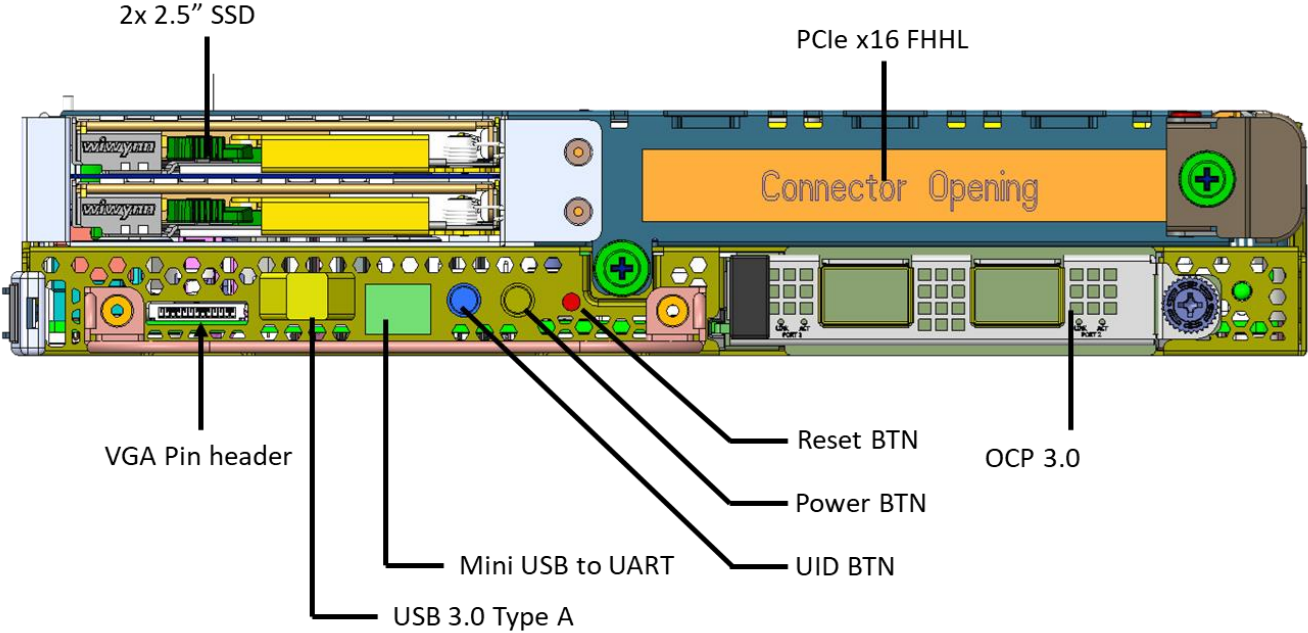

Figure 11: 1U Sled Front View