

THIS DRAWING CONTAINS INFORMATION PROPRIETARY TO POSITRONIC AND ITS SUBSIDIARIES. POSITRONIC BELIEVES THE DATA ON THIS DRAWING TO BE RELIABLE, SINCE THE TECHNICAL INFORMATION IS GIVEN FREE OF CHARGE, THE USER EMPLOYS SUCH INFORMATION AT HIS OWN DISCRETION AND RISK. POSITRONIC ASSUMES NO RESPONSIBILITY FOR RESULTS OBTAINED OR DAMAGES INCURRED FROM USE OF SUCH INFORMATION IN WHOLE OR IN PART.

DATE	REV	REVISION RECORD	APP	DR	CK
09-01 20	D	ECO 76884	CM	EH	JH

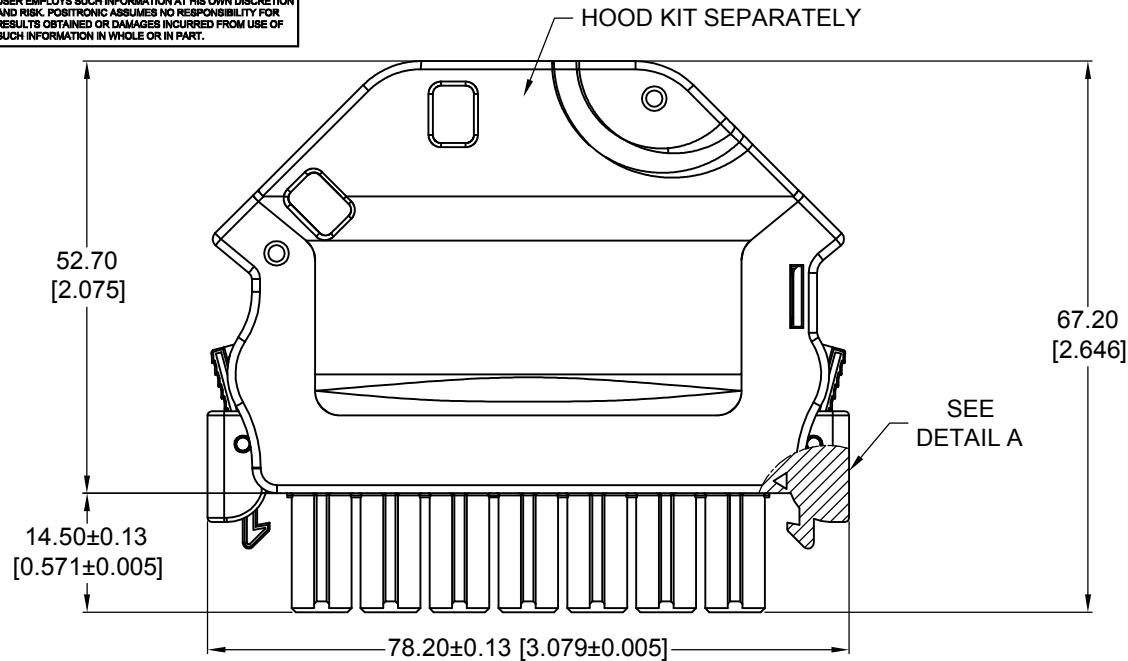

**DETAIL A
(SCALE 2X)**

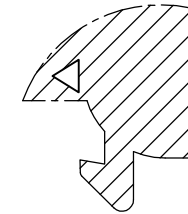

"◁" INDICATE STARTING POINT
OF CONTACT POSITION 1

**DETAIL B
(SCALE 2X)**



"◁" INDICATE STARTING POINT
OF CONTACT POSITION 1

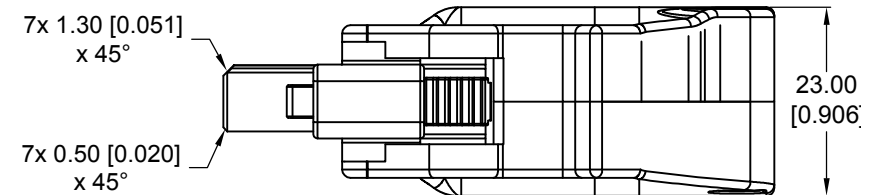
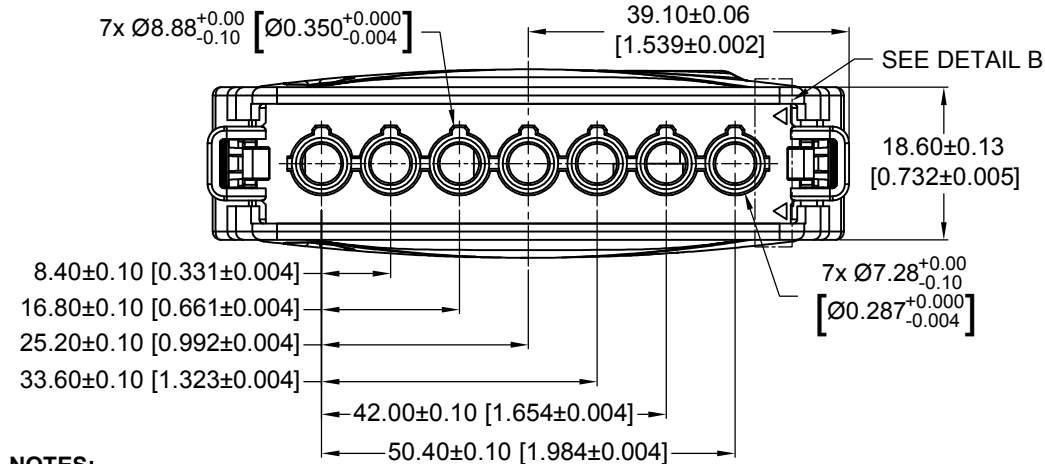

NOTES:

- MATERIALS AND FINISHES:**
INSULATOR : GLASS-FILLED POLYESTER, UL 94V-0. COLOR: BLUE (HALOGEN-FREE).
HOOD: GLASS-FILLED POLYESTER, UL 94V-0. COLOR: BLACK (HALOGEN-FREE), KIT SEPARATELY.
LATCH: PPO, UL 94V-0. COLOR: BLACK (HALOGEN-FREE).
SCREWS: STEEL, ZINC PLATE WITH CHROMATE SEAL. KIT SEPARATELY.
CONTACTS: ORDER CONTACTS SEPARATELY.
- COMPLIANT TO THE CURRENT ROHS DIRECTIVE.
- THIS MOS ALLOWS FOR THE CONNECTOR TO BE SUPPLIED WITH SPECIAL CONTACTS MODULES WHICH ALLOWS FOR TOUCH SAFE FEATURE.
THIS MOS ALSO ALLOWS FOR SPECIAL HOOD DESIGNED FOR OCP WHICH HAS 45° CABLE OPENING.

		POSITRONIC INDUSTRIES INC.	
SPRINGFIELD, MISSOURI 65801			
	DECIMAL TOL. ±0.38 [0.015]	SCALE N.T.S.	DRAWN BY EH
	ANGULAR TOL. ±5°	TITLE FEMALE CONNECTOR	APPROVED BY SAMY
DATE 11-22-19	DRAWING NUMBER SP10RSSS1FOW01/AA-2268	REV. 1 OF 2 D	

THIS DRAWING CONTAINS INFORMATION PROPRIETARY TO POSITRONIC AND ITS SUBSIDIARIES. POSITRONIC BELIEVES THE DATA ON THIS DRAWING TO BE RELIABLE, SINCE THE TECHNICAL INFORMATION IS GIVEN FREE OF CHARGE, THE USER EMPLOYS SUCH INFORMATION AT HIS OWN DISCRETION AND RISK. POSITRONIC ASSUMES NO RESPONSIBILITY FOR RESULTS OBTAINED OR DAMAGES INCURRED FROM USE OF SUCH INFORMATION IN WHOLE OR IN PART.

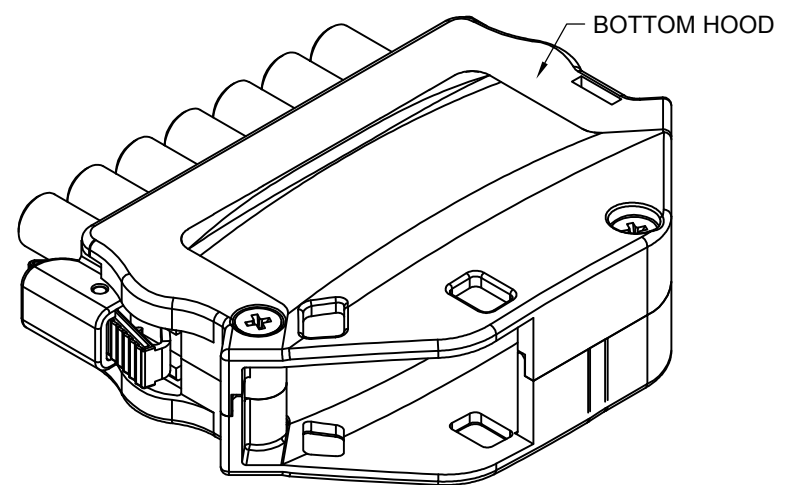
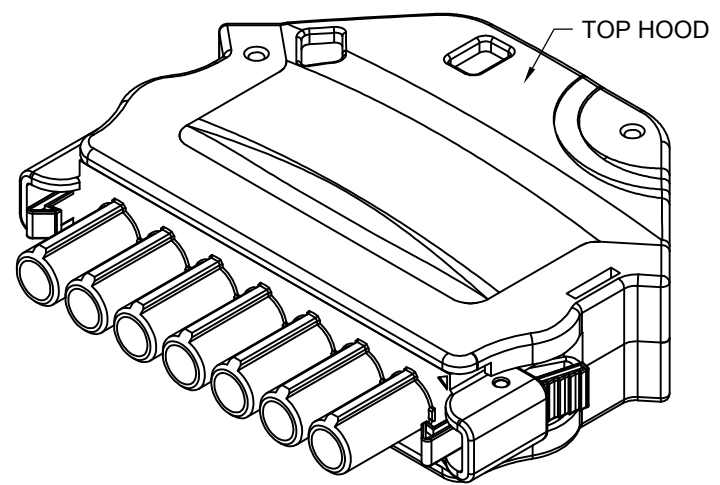

HOOD AND SCREWS: KIT SEPARATELY

